



Application Data Sheet

AC2212/00

SPECIFICATIONS

ACOUSTIC & ELECTRICAL SPECS:

PASSIVE MODE:

Nominal Impedance: 8 ohms
Sensitivity: 95 dB-SPL
Crossover Frequencies: 1.3 kHz

BI-AMP MODE:

Nominal Impedance: LF: 8 ohms
HF: 8 ohms
Sensitivity: LF: 95 dB-SPL
HF: 109 dB-SPL
Crossover Frequency: Active: 1.3 kHz, 24 dB/oct L-R*

IMPORTANT: In Biamp mode, SonicGuard overpower protection is not in circuit. To protect speaker from damage from overpowering or from amplifier clipping, include active limiter set to proper threshold and time constant for each frequency band.

**Use of digital crossover highly recommended. Time alignment of components via delay is necessary for proper performance. Check www.jblpro.com/ae for the most recent crossover recommendations.*

POWER HANDLING:

	BI-AMP MODE:		PASSIVE MODE:	
	2 hr AES	100 hr AES	2 hr IEC	100 hr IEC
LF	300 W	250 W	300 W	250 W
HF	50 W			

SYSTEM COMPONENTS:

LF Driver: M112-8A 300 mm (12 in)
HF Driver: 2418H/MTA compression driver

PHYSICAL SPECIFICATIONS:

Enclosure Dimensions: 548 x 355 x 352 mm
H x W x D (21.6 x 14.0 x 13.9 in.)
Net Weight: 19.1 kg (42 lb)

Refer to the product specification sheet for specification test and measurement conditions.

CHANGING CROSSOVER MODE (From Passive to Bi-Amp)

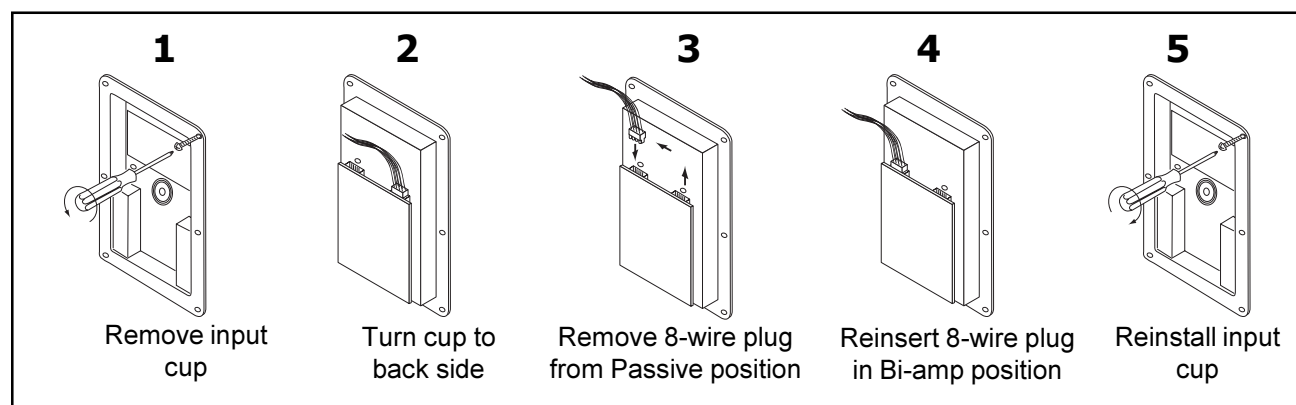

ACCESSORIES

Included: Secondary JBL Grille Badge (orange), adheres on top of stock Grille Badge. Note: Stock grille badge is rotatable.

Optional: MTU-4 -- U-Bracket

229-00009-01 -- 3 pcs 10 mm diameter x 35 mm-thread forged shoulder steel eyebolts.

Check www.jblpro.com/ae for further information about this item and for other brackets or rigging hardware.

BOLT WARNING FOR BRACKETS AND RIGGING

Do NOT use the stock 10 mm flathead screws that come with the cabinet for attaching brackets or rigging. Use only load-rated bolts, which may come with the bracket or rigging system.

SUSPENSION WARNING

Suspending Cabinet To Be Done Only by
Qualified Personnel Using Safe Rigging Practices.

DETAILED DIMENSIONAL DIAGRAM

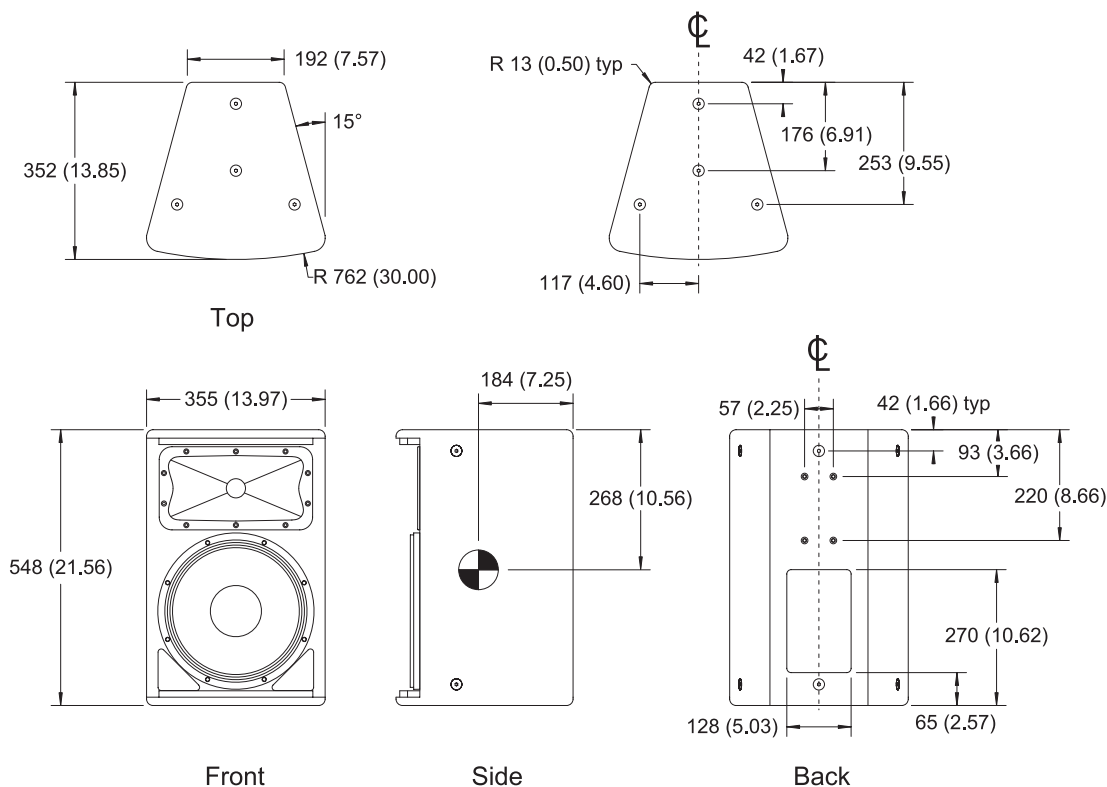

ENVIRONMENTAL CONSIDERATIONS

This loudspeaker is not intended for use as an outdoor speaker. An outdoor version of this speaker can be ordered from JBL. Contact JBL Professional for information.

RECOMMENDED DSP SETTINGS

Check www.jblpro.com/ae for the most recent recommended DSP tunings.

Note: Be aware that the end-result of identical panel settings on different digital signal processors can vary.



HA Harman International Company

JBL Professional
8500 Balboa Blvd.
Northridge, CA 91329 U.S.A.
818-894-8850

ADS AC2212/00
339390-021
Ver A 04/02